

## ADEMCO 5828/5828V

### Wireless Bidirectional Fixed-Word Keypads

#### INSTALLATION AND SETUP GUIDE

#### GENERAL INFORMATION

The ADEMCO 5828 and 5828V are wireless, bidirectional, fixed-word, keypads that may be used in conjunction with LYNX and VISTA series residential control panels. VISTA systems require use of either a 5883 Transceiver (micro P/N WAK5119-X, where X = 3 or higher), 6150RF Keypad/Transceiver (PC board P/N SA6150RFAS-T3 or higher), or 6160RF Keypad/Transceiver. The 5828/5828V keypads are not compatible with commercial control panels that have three-digit zone numbers (e.g., VISTA128BP).

Both keypads provide:

- Four programmable special function keys
- Wall-mount plate for easy removal of the keypad and battery replacement
- Optional Desktop mount /AC adapter kit, ADEMCO P/N 5828DM)

Battery-powered with 3-AA batteries

The 5828V keypad additionally provides:

- Memo/Message center
- Voice Response – system status, zone information, and alarms with zone information
- Stored Message LED indication
- Built-in microphone and speaker

#### NOTES:

- The 5828/5828V cannot be used as the primary system keypad, and may not be used to program or test any security system. All systems require a hardwired keypad (or Compass Downloader) to do so. Once programmed, the 5828/5828V can be used to initiate all common functions of a fixed English keypad.

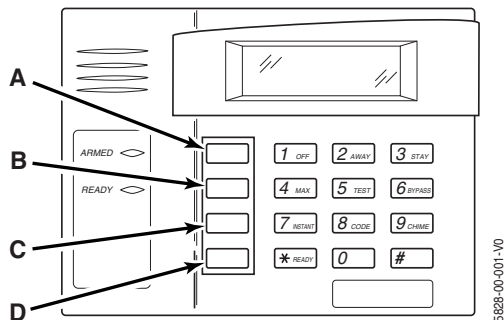

5828 Keypad with Front Cover Removed

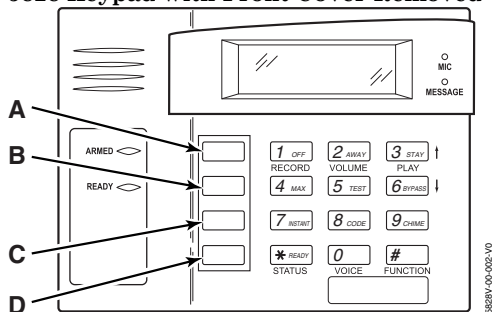

5828V Keypad with Front Cover Removed

#### Operation (See NOTE below)

1. **Battery-Powered Operation:** When powered by battery, the keypad activates when **any key is pressed**. When the [\*] key is pressed, the keypad sends a system status request, and displays and/or annunciates the present status transmitted by the system.
2. **AC-Powered Operation:** When powered by AC, the keypad remains active at all times. Any change in system status will cause the display to automatically turn on (if blank) and display/annunciate the new status.

If AC power is lost, the keypad will revert to battery-powered operation until AC power is restored and a new status request is made ([\*] key).

**NOTE:** Whether the unit is powered by battery or AC, the 5828/5828V may take up to 5 seconds to display and/or annunciate the new status after pressing the [\*] key.

**UL NOTE:** For UL985 installations use the battery powered keypad only.

#### WALL MOUNTING

Before mounting the 5828 & 5828V permanently, determine a good RF location as follows:

- If interfacing to a LYNX panel, try communicating with the panel from different locations.
- If interfacing to a VISTA panel, perform a Go/No Go test from the panel. Refer to the Go/No Go test mode in the Installation and Setup Guide for the panel.

Avoid mounting locations on or near large metal objects, since these can decrease the transmission range or block transmissions.

- Secure the mounting plate to the wall, using proper sized hardware through the six mounting holes.
- Plug the cord from the optional power pack into the keypad's DC input connector, and route the wires through the wire guides on the back of the keypad.
- Position the keypad over the mounting plate and slide down, engaging the four retaining clips on the plate with the receptacles on the keypad.

#### DESKTOP MOUNTING

For full portability, the keypad may be placed in any convenient, **RF-suitable** location and operated in its battery-powered mode, or near an AC outlet to be powered by the optional Power Pack/Desktop Mounting Kit, ADEMCO P/N 5828DM.

#### BATTERY INSTALLATION OR REPLACEMENT

**CAUTION:** Remove the AC/DC power connector from the keypad (if applicable), before attempting to install or replace the batteries.

1. Separate the keypad from its mounting plate by sliding the keypad up and away from the mounting plate.
2. Open the battery compartment door to expose the batteries.

3. Install or replace the 3-1.5 Volt AA batteries in the battery compartment. Always replace all three batteries at once to ensure normal operation of the keypad over the anticipated battery lifetime. Make sure that battery positive (+) and negative (-) terminals are properly oriented with the battery spring clip connections. Refer to battery placement graphic below.

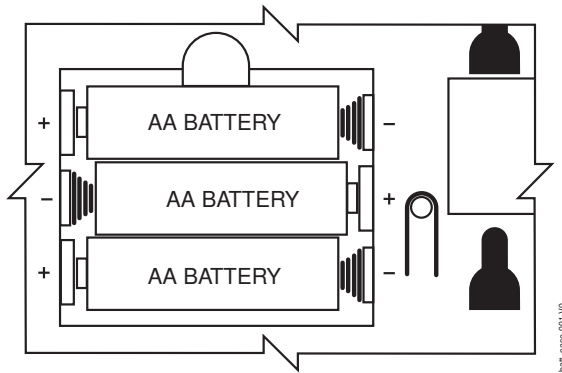

**Battery Compartment**

4. Reattach the keypad to its mounting plate by aligning the four mounting holes in the keypad case back with the four mounting clips on the mounting plate. Lower the keypad onto the clips.

### PROGRAMMING

The following two items must be programmed in the keypad by the installer.

- House ID Code (Step 1 in Installer Programming mode)\*
- System Type (Step 2 in Installer Programming mode)

\*The same House ID Code must also be programmed in the control panel. Programming a different House ID will disable communication.

### Installer Programming

Enter the program mode by pressing the [1] and [3] keys simultaneously for five (5) seconds. The display alternately flashes "00" and two dashes (--).

#### NOTES:

- Entering a value other than one specified in the following steps may cause unpredictable results.
- This keypad exits programming mode 15 seconds after the last key is pressed. Pressing any key will extend the 15-second active time. If the unit times out before you have pressed the star (\*) key to save a programmed value, you will need to re-enter the Programming mode and reprogram the option.

STEP	ACTION	DISPLAY
1.	Press [1] (House ID Code) (10 = default) Enter the two-digit house code (01-31) Press [*] to continue.	Alternately flashes "t1" and the 2-digit house code.
2.	Press [2] (System Type). Press (1) for VISTA Press (2) for LYNX (2 = default) Press [*] to continue.	Alternately flashes "t2" and (1 or 2)

3.	Press [3] (Exit Delay) Press 0-9 in 15 second increments. Example: If you press 3, exit delay would be 3 times 15 seconds for a total of 45 seconds. <b>NOTE:</b> The Exit Delay programmed here should match the Exit Delay programmed in the control panel. (0 = default) Press [*] to continue.	Alternately flashes "t3" and value selected.
4. (5828V only)	Press [4] (Voice enable/disable). Press (0) to disable. Press (1) to enable. (1 = default) Press [*] to continue.	Alternately flashes "t4" and (0 or 1)
5.	Press [5] (Wireless Protocol). Press [1] for <b>original LYNX</b> controls Press [2] for <b>LYNXR, LYNXR-EN, or VISTA controls</b> (2 = default) Press [*] to continue.	Alternately flashes "t5" and (1 or 2)
6.	Press [6] (Function Key Select). Press [0] for Panic Key Press [1] for Single-button arming <b>NOTE:</b> The programming here must match the programming of the control panel to simplify end user operation. (1 = default.) Press [*] to continue.	Alternately flashes "t6" and (0 or 1)
7.	Press [7] (Restore Defaults). Press [1] to restore factory settings. Press [*]. <b>Exit programming mode.</b>	Displays "EE"

### Exiting Programming Mode

You can exit programming mode by pressing the [\*] key whenever the small 00 and (- -) are alternately displayed.

### Programming or Changing a User Code (Required if using Quick Arm function on LYNX or VISTA)

Enter user program mode by pressing the [7] and [9] keys at the same time until the display flashes double dashes (- -).

Enter the desired 4-digit user code that matches a user code programmed in the control panel. **There will be no display of the user code entered.**

Press the [\*] key to place the 4-digit code in memory and exit the user program mode.

### SPECIAL FUNCTION KEYS

As shown in the figures on page 1, each keypad contains four Special Function keys (A, B, C, D) that may be programmed to execute the commands shown below.

**NOTE:** The Function Key Select setting in Step 6 of the INSTALLER PROGRAMMING procedure above determines the operation of the Special Function keys A, B, C, and D as follows:

**If you select "0"**

Function Key	Function	Message Sent to Control
A	[1] + [*]	(Alarm zone 95)
B	[*] + [#]	(Alarm zone 99)
C	[3] + [#]	(Alarm zone 96)
D	(Not used for panic alarms)	

**NOTE:** Do **NOT** use the 5828V for silent panic operation because the keypad itself is not silent.

If you select “1” (normally used on LYNX controls)

Function Key	Function
A	“Off”
B	Arms “AWAY”
C	Arms “STAY”
D	(For future use)

### MEMO/MESSAGE CENTER

The MESSAGE CENTER table that follows explains what can be done using the message center of the 5828V, and the keys to press to enable each function.

**NOTE:** Allow any status annunciation to complete before starting to record a message.

MESSAGE CENTER (LYNX)	
TO:	PRESS:
Record a message:	# + 1
Stop recording before end of 20 seconds:	1
Playback a message:	# + 3
Adjust message playback volume:	# + 2 + 3↑ or 6↓
Mute keypad status announcements:	# + 2 + 1
Restore keypad status announcements:	# + 2 + 3↑ or 6↓
MESSAGE CENTER (VISTA)	
TO:	PRESS:
Record a message:	# + 0 + 1
Stop recording before end of 20 seconds:	1
Playback a message:	# + 0 + 3
Adjust message playback volume:	# + 0 + 2 + 3↑ or 6↓
Mute keypad status announcements:	# + 0 + 2 + 1
Restore keypad status announcements:	# + 0 + 2 + 3↑ or 6↓

**New message indication:** When the keypad is activated in battery-powered mode and a new message is waiting, the red message LED will blink until the keypad turns off or the message is played back.

When powered by AC, if a new message is waiting, the red message LED will blink continuously until the stored message has been played back.

**NOTE:** When programming zone descriptors in the panel, you must select from words supported by both the 5828V (shown in Table 1 below) and words supported by the control panel. If you use any other words, the 5828V will **not** annunciate them. Refer to the control panel’s Installation and Setup Guide for specific instructions on programming zone descriptors.

**TABLE 1. ZONE DESCRIPTORS**

ALARM	DOOR	GUN	MOTION	SEVEN	THREE
ATTIC	EIGHT	INSIDE	NINE	SHED	TWO
BABY	EMERGENCY	INSTANT	OFFICE	SHOP	UPSTAIRS
BACK	EXIT	KITCHEN	ONE	SIDE	UTILITY
BASEMENT	FIRE	LAUNDRY	OPEN*	SIX	WINDOW
BATHROOM	FIRST	LIBRARY	PANIC*	SLIDING	YARD
BEDROOM	FIVE	LIVING	PATIO	SMOKE	ZERO
CHECK	FLOOR	MAIN	POOL	STORAGE	ZONE
DEN	FOUR	MASTER	MOTION	SEVEN	
DETECTOR	FRONT	MEDICAL	ROOM	SYSTEM	
DINING	GARAGE	MESSAGE**	SECOND	THIRD	

\* These Descriptors are available with VISTA series control panels ONLY.  
 \*\* This Descriptor is available with Lynx series control panels ONLY.

**NOTE:** If using a LYNX control, and the word “MESSAGE” is announced at the 5828V keypad, it means that there is a message waiting **at the control panel**, which can only be retrieved using the LYNX keypad.

**To delete a message:** Recording a new message will overwrite the old one.

**Muting system status announcements** has **NO** effect on the message recording or playback capability.

**If volume is adjusted** (3↑ or 6↓) when a message is played back, and the user still wants system status announcements to be muted, the user must **again** mute system status announcements (# + 2 + 1 for LYNX or # + 0 + 2 + 1 for VISTA).

### POWER CONNECTIONS

In a typical configuration, the 5828 and 5828V keypads are powered by 3-AA batteries.

The 5828 and 5828V keypads can also be powered from an optional Power Pack/Desktop Mounting Kit. See detailed specifications for the Kit on the next page.

It is recommended that three AA batteries be installed as a backup power source when using the Power Pack/Desktop Mounting Kit.

### SUPERVISION

A 5828/5828V keypad low battery condition will be displayed as “BAT” on Zone “00” until the battery drops below a minimum level and the display goes blank.

The 5828/5828V does not display three-digit conditions, such as a keypad or receiver supervision failure. It will only display the last two digits of the supervision zone number. Therefore, it is recommended for VISTA-10P/15P/20P and variants that you set program field \*199 (ECP Fail Display) as a “1” (two-digit display). This will cause the keypad to display Zone 91 as a supervision failure of any device on the keypad (ECP) bus.



1. If installing a Lynx series system, please note that compound zone descriptors supported by the Lynx such as “living room” are not supported on the 5828V, and should be programmed as two single words, “living” and “room.” Also note that the Lynx Voice Prompt Programming mode uses these compound words when applicable. These words should be reprogrammed as two single words in order to be announced by the 5828V.
2. When using a VISTA-40 or VISTA-50P control panel, you must program zone descriptors in order for the panel to announce the zone status correctly.

**SPECIFICATIONS:**

Physical:	6-1/4" W x 4-3/4" H x 1-3/8" D (159mm x 121mm x 35mm)
Frequency of Operation:	345 MHz
Batteries:	3 AA, 1.5 Volt Alkaline, ADEMCO part no. 468 Anticipated battery life is 1.5 years.
Power Pack/Desktop Mounting Kit (optional):	110VAC input, 5.0 Volt Regulated DC output, 220mA, ADEMCO P/N 5828DM
Display:	Fixed-Word Liquid Crystal
Sounder:	Speaker

**FEDERAL COMMUNICATIONS COMMISSION (FCC) STATEMENTS**

The user shall not make any changes or modifications to the equipment unless authorized by the Installation Instructions or User's Manual. Unauthorized changes or modifications could void the user's authority to operate the equipment.

**FCC IC STATEMENT**

This device complies with Part 15 of the FCC Rules and RSS-210 of Industry Canada. Operation is subject to the following two conditions: (1) This device may not cause harmful interference. (2) This device must accept any interference received, including interference that may cause undesired operation.

Cet appareil est conforme à la partie 15 des règles de la FCC & de RSS-210 des Industries Canada. Son fonctionnement est soumis aux conditions suivantes : (1) Cet appareil ne doit pas causer d'interférences nuisibles. (2) Cet appareil doit accepter toute interférence reçues, y compris les interférences causant un réception indésirable.

**FCC CLASS B STATEMENT**

This equipment has been tested to FCC requirements and has been found acceptable for use. The FCC requires the following statement for your information:

This equipment generates and uses radio frequency energy and if not installed and used properly, that is, in strict accordance with the manufacturer's instructions, may cause interference to radio and television reception. It has been type tested and found to comply with the limits for a Class B computing device in accordance with the specifications in Part 15 of FCC Rules, which are designed to provide reasonable protection against such interference in a residential installation. However, there is no guarantee that interference will not occur in a particular installation. If this equipment does cause interference to radio or television reception, which can be determined by turning the equipment off and on, the user is encouraged to try to correct the interference by one or more of the following measures:

- If using an indoor antenna, have a quality outdoor antenna installed.
- Reorient the receiving antenna until interference is reduced or eliminated.
- Move the radio or television receiver away from the receiver/control.
- Move the antenna leads away from any wire runs to the receiver/control.
- Plug the receiver/control into a different outlet so that it and the radio or television receiver are on different branch circuits.
- Consult the dealer or an experienced radio/TV technician for help.

**INDUSTRY CANADA CLASS B STATEMENT**

ICES-003 Class B Notice - Avis NMB-003, Class B

This Class B digital apparatus complies with Canadian ICES-003.

Cet appareil numérique de la classe B est conforme à la norme NMB-003 du Canada.

**WARRANTY INFORMATION**

For the latest warranty information, please visit:

[www.honeywell.com/security/hsc/resources/wa](http://www.honeywell.com/security/hsc/resources/wa)

# Honeywell

2 Corporate Center Drive, Suite 100

P.O. Box 9040, Melville, NY 11747

Copyright © 2011 Honeywell International Inc.

[www.honeywell.com/security](http://www.honeywell.com/security)



K0020V4 7/11 Rev. B